

Thence Just over latter Hub

set dist as on spot st split was
 P.D. on mt #31 (Grant + 24th) Base
 Thence Just over mt #5 (24th wash)
 of building (shows the stone)

Angle B + north set back in water table
 Thence Just over latter Hub P.D. on mt #9
 been 381.15' set Hub 381.220'

and stake pin at 381.20' showed how
 thence chained East from mt #9
 set pin for center with distance
 chained West from mt #4 387.65' -
 P.D. on mt #9 Grant + 24th st
 Just over mt #4 Washington and 24th st

25 Plat 'a
 North + South through Block
 59th wide East Running
 Survey to open Street

Monday Am. May 2nd, 1890

mt #9

Grant Ave

mt #31

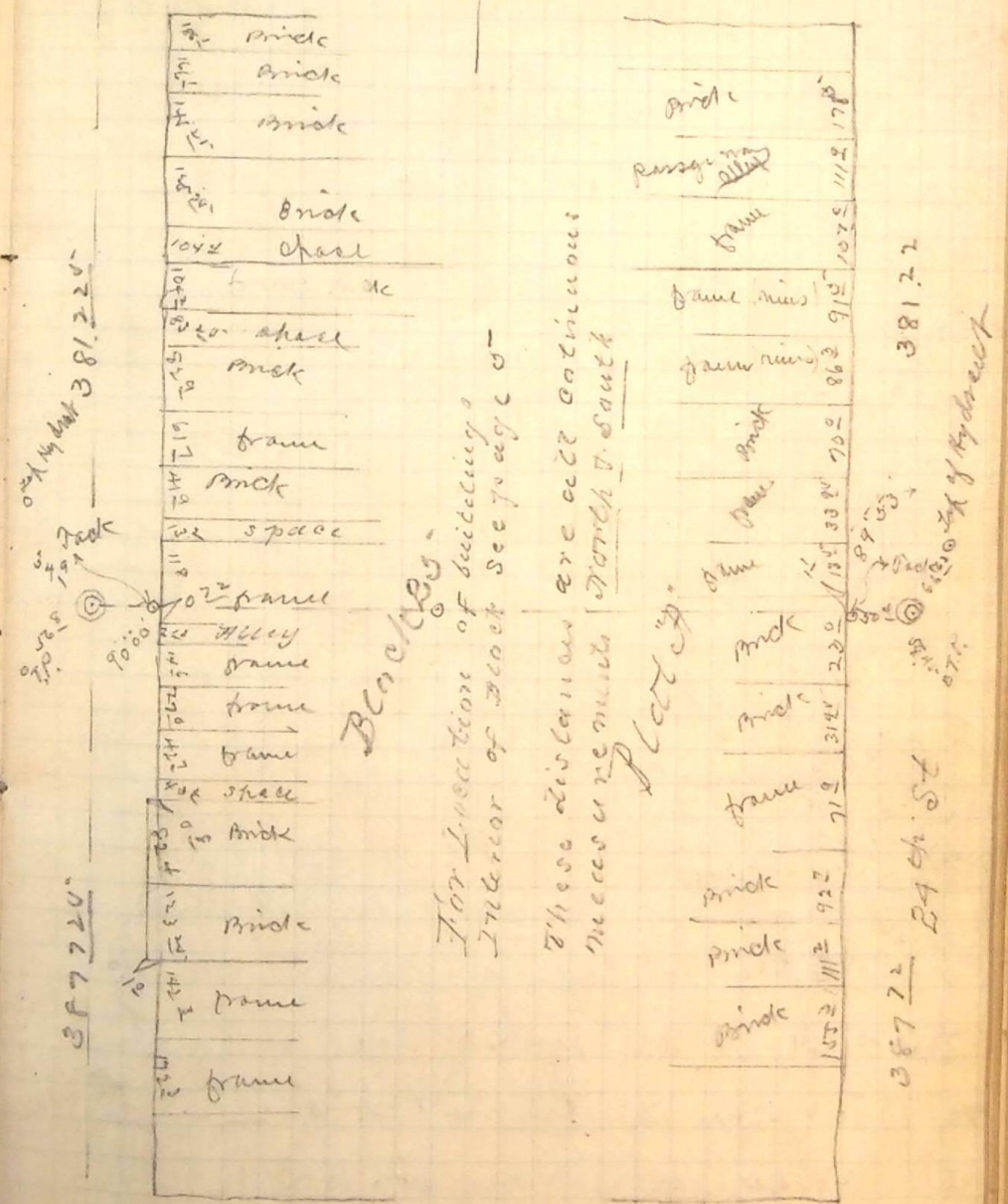

mt #9 381.220'

Deck

Bridges

For Location of buildings Interior of Block see page 6

These distances are all continuous necessary measurements

Plat 25

25' 10' 1/2 of Hydrograph

mt #4

Washington Ave

mt #31